



**AWAIR<sup>®</sup>** Omni<sup>™</sup>

**Quick Start Guide**

[getawair.com](https://getawair.com)

# Breathe Easy

Omni tracks your air health and lets you know if there is an issue, helping you create a healthy, comfortable, and productive indoor environment.

## Sensors



Fine Dust



Chemicals (TVOCs)



CO<sub>2</sub>



Humidity



Temperature



Noise

## What's Inside

- Awair Omni
- Power Adapter
- USB Cable
- Quick Start Guide
- Stand
- Wall Mount Unit\*  
(\*enterprise model only)

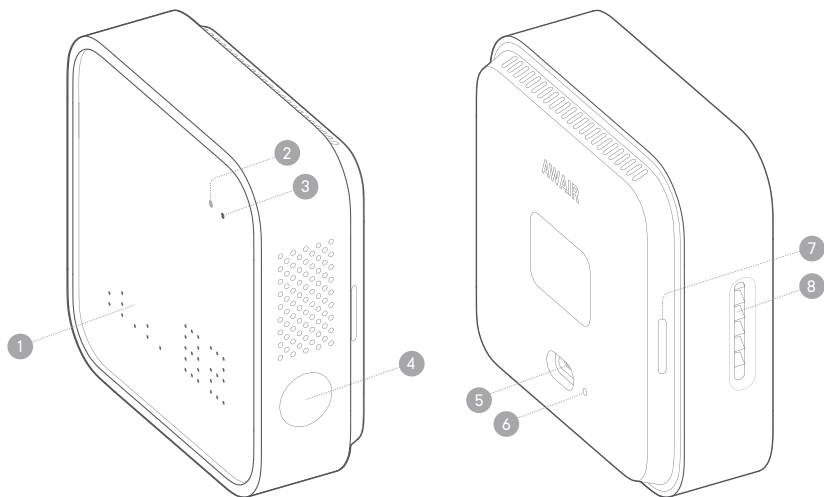

## Parts

- |                      |                   |                        |
|----------------------|-------------------|------------------------|
| 1 LED Matrix Display | 2 Light Sensor    | 3 Air Status Indicator |
| 4 Power Button       | 5 Power Connector | 6 Reset Button         |
| 7 Accessory Snap     | 8 Air Intake Vent |                        |

## Get Started

- 1. Plug** the USB power cable into your Awair Omni and plug the power adapter into a wall outlet.

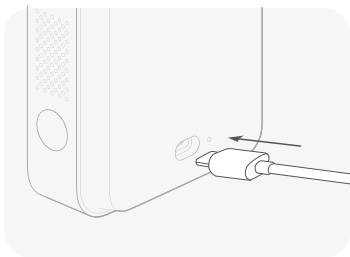

- 2. Power on** Omni by pressing the power button on the side.

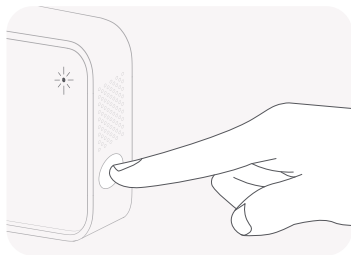

- 3. Download** the Awair app from the Apple App Store or Google Play Store.

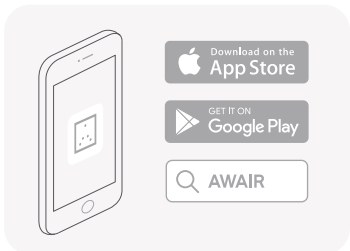

- 4. Follow** the instructions on the App screens for next steps.



## Important Information

- Make sure Awair Omni is within range of your wireless network.
- Please connect Omni to 2.4GHz Wi-Fi network.  
It does not currently support 5GHz.
- Please get more detailed information at <http://support.getawair.com>
- If you have any questions, please contact us at [hello@getawair.com](mailto:hello@getawair.com)

## Each Color on Omni's Display Represents

- **Green:** Good Air
- **Yellow:** Fair Air
- **Red:** Poor Air
- **Blue:** Bluetooth
- **Purple:** Wi-Fi
- **White:** Device Setting, Update

## **FCC Statement**

This equipment has been tested and found to comply with the limits for a Class B digital device, pursuant to part 15 of the FCC rules. These limits are designed to provide reasonable protection against harmful interference in a residential installation. This equipment generates, uses and can radiate radio frequency energy and, if not installed and used in accordance with the instructions, may cause harmful interference to radio communications. However, there is no guarantee that interference will not occur in a particular installation. If this equipment does cause harmful interference to radio or television reception, which can be determined by turning the equipment off and on, the user is encouraged to try to correct the interference by one or more of the following measures:

- Reorient or relocate the receiving antenna.
- Increase the separation between the equipment and receiver.
- Connect the equipment into an outlet on a circuit different from that to which the receiver is connected.
- Consult the dealer or an experienced radio/TV technician for help.

To assure continued compliance, any changes or modifications not expressly approved by the party

## **FCC Radiation Exposure Statement**

This equipment complies with FCC RF radiation exposure limits set forth for an uncontrolled environment. This transmitter must not be co-located or operating in conjunction with any other antenna or transmitter. This equipment complies with Part 15 of the FCC Rules. Operation is subject to the following two conditions: (1) This device may not cause harmful interference, and (2) This device must accept any interference received, including interference that may cause undesired operation.

## **Caution**

The manufacturer is not responsible for any radio or TV interference caused by unauthorized modifications to this equipment. Such modifications could void the user authority to operate the equipment

## Safety

1. Awair Omni should be powered with the provided adaptor in its original box. It will not work with accessories from other manufacturers.
2. Do not disassemble or open Awair Omni. Disassembling and opening Awair Omni is very dangerous when it is connected to any power outlet. Disassembly of Omni will void your warranty.
3. Awair Omni is designed for residential settings and to be used indoors in a dry location. Avoid liquid contact with Awair Omni. Do not submerge Omni in liquid or attempt to clean it with liquids or solvents. To clean Omni, disconnect from the power outlet and use a damp towel.
4. Do not insert any objects into the openings or ventilation holes.
5. There should be at least a 2 inch clearance for every vent hole if you are placing your Awair Omni near walls or any objects.
6. Do not use DC adapter from other manufactures for charging the battery and operation. It will damage the battery and Awair Omni.
7. Don't attempt to replace the Awair Omni battery yourself. The lithium-ion Polymer battery in Awair Omni should be replaced by Awair or an authorized service provider. Improper replacement or repair could damage the battery, cause overheating, or result in injury. The battery must be recycled or disposed of separately from household waste. Don't incinerate the battery. (\*Battery is optional)

## Warranty

Duration and Coverage. **One (1) year Limited Hardware Warranty.** Subject to the additional terms and conditions set forth below, Awair provides the following Limited Warranty only to the person or entity that originally purchased the Device from Awair or from one of its authorized resellers or distributors;

Awair warrants the Device against defects in materials and workmanship under normal use for a period of one (1) year from the date of original purchase ("Warranty Period").

If a Device is returned to Awair during the Warranty Period as provided below, and Awair determines that the Device is defective, Awair will either repair or replace the unit with either a new or a refurbished Awair, or refund the original purchase price (less any discounts or promotional codes) in return for the Device, at its option. If the Warranty Period has expired or is otherwise not applicable as per the Scope and Limitation on Warranty, we will return the Device to you.

More information about this warranty can be found at <http://support.getawair.com>.



# Product Specifications

## Sensors

- Dust (PM2.5/PM10):  
0 to 1,000µg/m³ ±15µg/m³ or 15%
- TVOCs: 0 to 60ppm ±10%
- CO<sub>2</sub>: 400-5,000ppm ±75ppm or 10%
- Temperature: -40 to 125°C (-40 to +257°F) ±0.2°C
- Humidity: 0 to 100% ±2%
- Ambient light: 0.96 to 64,000lux
- Ambient noise sensor:
  - Sensitivity: -26dBFS
  - SNR (Signal to Noise Ratio): Typical 61dB  
(A-weighted, 20Hz~20kHz)

## Dimensions

- Width: 3.85 inch (98mm)
- Height: 3.85 inch (98mm)
- Depth: 1.35 inch (34.5mm)

## Supported Wireless Security

- WPA, WPA2

## Operating Temperature

- Operating temperature: 0 to 45°C (32 to +113°F)
- Storage temperature: 0 to 85°C (32 to +185°F)

## Power Adapter

- Input: AC 100/240V, 50/60Hz, USB-C
- Output: 5V/2.0A external power adapter

## Power Consumption

- With battery charging: Max 6.5W
- Operating: Avg 1.76W (Max 2.6W)
- Less than 1.3kWh per month  
(operating for 24h and 30 days)

## Wireless

- Working Wi-Fi connection:  
802.11 b/g/n @2.4 GHz
  - IEEE 802.11b: 1-11Mbps
  - IEEE 802.11g: 6-53Mbps
  - IEEE 802.11n: 7.2-150Mbps
- Bluetooth 4.1

## System Requirements

- Wi-Fi connection
- Smartphone or tablet with iOS 9  
or later, or Android 4.4 or later
- Free Awar account

## Certifications



 MSIP-CRM-BIQ-AWAIR  
XU101305-17001A

FCC ID 2AF65AWAIR

CMIIT ID 2017DJ7338

## Battery (\*Battery is optional)

Capacity and voltage: 2250mAh @3.7V

Lithium-ion Polymer

KC Battery: XU101305-17001A

Cell: UL1642 (Standard for Lithium Batteries)

Pack: CB (Certification Body)

Transport Certification: UN38.3 (To ensure air transport safety, and to meet customer demand for transport of cargo containing lithium batteries, according to IATA "Dangerous Goods Rules," the relevant provisions of the development of a rechargeable battery operating specifications)

## Stand Removal

Gently pull the indicated side slot in the direction of the arrow.  
Do not pull the leg of the stand, as that motion can cause damage.

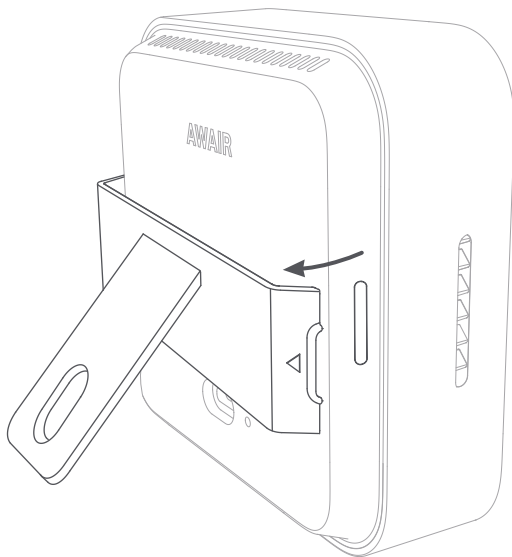

## Wall Mount Installation(\*enterprise model only)

Fasten your AWAIR Omni to your wall with the wall mount unit included in this package. You can install the wall mount by applying the provided double-sided tape, or with the enclosed screws and anchors.

To fasten the wall mount with screws, first fasten one screw in the top screw hole, using the provided level for reference, and follow with the second screw

